

**Desert Crete Deck to Threshold**  
**HILL BROTHERS CHEMICAL COMPANY**  
 1675 N. Main St. Orange, CA 92867 (714) 998-8800 Fax: (714) 998-6310

Date: 10/10/05  
 Issue: Standards  
 SCALE: 1/2" = 1"

Desert Crete Detail  
**103**

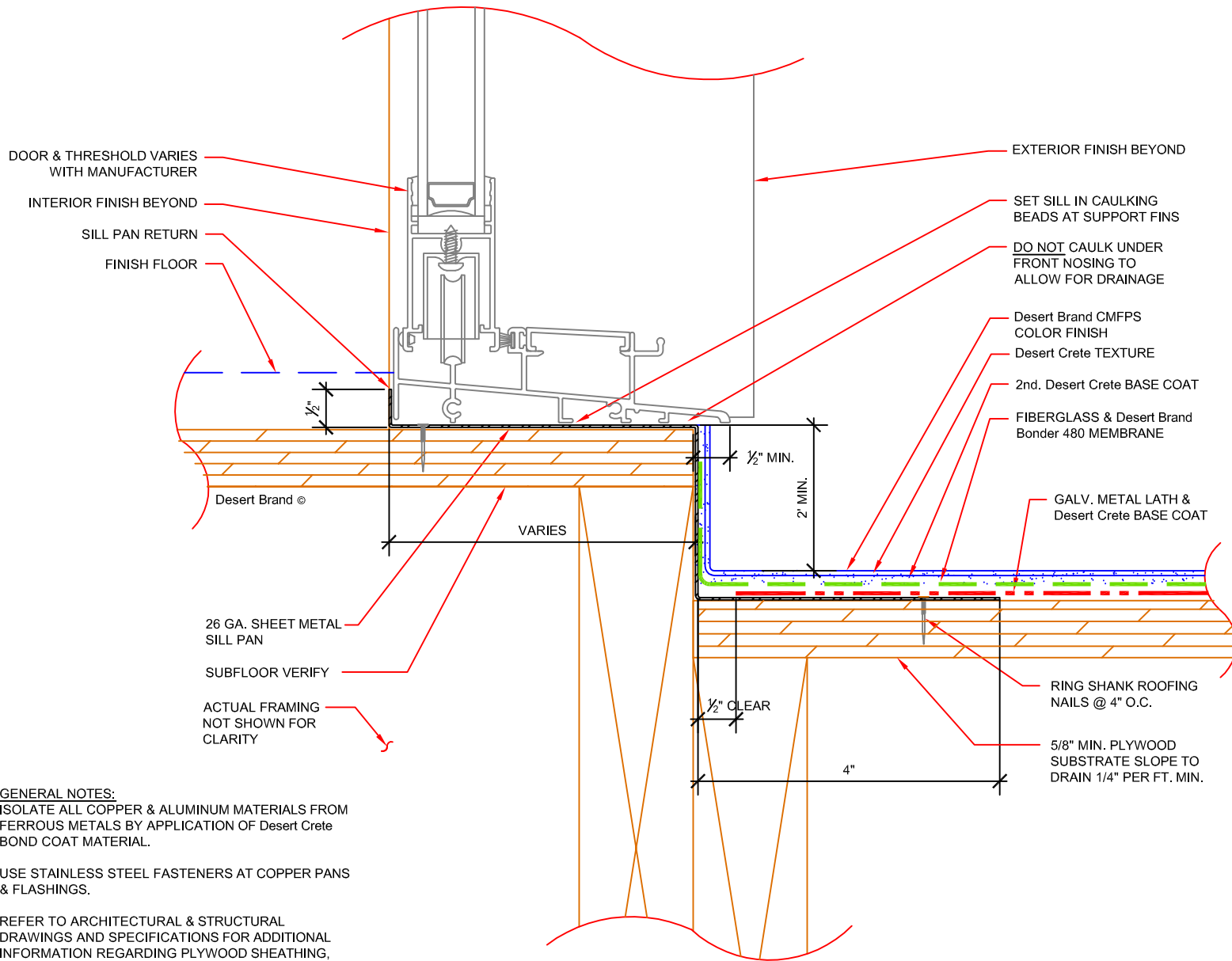

**GENERAL NOTES:**  
 ISOLATE ALL COPPER & ALUMINUM MATERIALS FROM FERROUS METALS BY APPLICATION OF Desert Crete BOND COAT MATERIAL.  
 USE STAINLESS STEEL FASTENERS AT COPPER PANS & FLASHINGS.  
 REFER TO ARCHITECTURAL & STRUCTURAL DRAWINGS AND SPECIFICATIONS FOR ADDITIONAL INFORMATION REGARDING PLYWOOD SHEATHING, FRAMING, BLOCKING AND SHEET METAL INSTALLATION.

- DOOR & THRESHOLD VARIES WITH MANUFACTURER
- INTERIOR FINISH BEYOND
- SILL PAN RETURN
- FINISH FLOOR
- EXTERIOR FINISH BEYOND
- SET SILL IN CAULKING BEADS AT SUPPORT FINIS
- DO NOT CAULK UNDER FRONT NOSING TO ALLOW FOR DRAINAGE
- Desert Brand CMFPS COLOR FINISH
- Desert Crete TEXTURE
- 2nd. Desert Crete BASE COAT
- FIBERGLASS & Desert Brand Bonder 480 MEMBRANE
- GALV. METAL LATH & Desert Crete BASE COAT
- Desert Brand ©
- VARIES
- 26 GA. SHEET METAL SILL PAN
- SUBFLOOR VERIFY
- ACTUAL FRAMING NOT SHOWN FOR CLARITY
- 1/2" MIN.
- 2" MIN.
- 1/2" MIN.
- 1/2" CLEAR
- 4"
- RING SHANK ROOFING NAILS @ 4" O.C.
- 5/8" MIN. PLYWOOD SUBSTRATE SLOPE TO DRAIN 1/4" PER FT. MIN.